

Glyden

Full HD Drone with Optical Flow and Wi-Fi FPV

USER MANUAL



ZERO-X[®]

Capture the skies.™

ZERO-X IS A PROUD DRONE SAFETY ADVOCATE



Test your knowledge at knowyourdrone.gov.au

Be aware of local legislations and read the instructions carefully before using your drone. Keep yourself and others safe when flying your Zero-X drone. Always fly your drone within visual line-of-sight and only fly one drone at a time. Do not allow your view of the drone to be impaired eg: in rain, wind, snow, fog or low light. When flying your drone, please keep in mind the safety and privacy of others.

Do not get your drone wet, dusty or sandy. Do not touch your drone while it is powered on and when the rotor blades are turning.

For replacement parts batteries, blades, and accessories please visit your nearest Zero-X retailer or visit www.zero-x.com.au | www.zero-x.co.nz

CONTENTS

1.0 WELCOME.....	3
1.1 BEFORE YOU GET UP IN THE AIR.....	3
1.2 GENERAL SAFETY.....	3
2.0 PRODUCT CONTENTS	4
2.1 PRODUCT OVERVIEW.....	4
2.2 REMOTE CONTROL OVERVIEW.....	5
3.0 BATTERY SAFETY	6
4.0 SETTING UP YOUR DRONE	8
4.1 INSTALLING THE BATTERY	7
4.2 INSTALLING ROTOR GUARDS.....	7
4.3 REMOTE CONTROL.....	8
4.4 SYNCING YOUR DRONE	8
4.5 YOUR DRONE IS READY TO TAKE OFF	9
4.6 FACTORY RESET FUNCTION	9
5.0 FLYING YOUR DRONE.....	10
5.1 FLIGHT SAFETY.....	11
5.2 BASIC FLIGHT	11
5.3 TRIM FUNCTION	12
5.4 SPEED MODE	13
6.0 CAMERA/VIDEO FEATURES	13
6.1 CAMERA MODE	13
6.2 VIDEO MODE	13
7.0 FLIP FUNCTION.....	14
8.0 HEADLESS MODE	14
9.0 EMERGENCY/STOP.....	15
10.0 OPTICAL FLOW POSITION	15
11.0 SAVING VIDEOS AND PHOTOS USING YOUR SMARTPHONE.....	15
12.0 DOWNLOADING THE ZX-FLY APP TO YOUR SMARTPHONE.....	16
12.1 WHERE TO DOWNLOAD	16
12.2 ZX-FLY APP	16
12.3 CONNECTING TO THE DRONE WI-FI	16
13.0 DRONE MAINTENANCE	17
13.1 REPLACING ROTOR BLADES	17
14.0 REPLACEMENT PARTS	18
15.0 WARRANTY TERMS AND CONDITIONS	19
NOTES	22

1.0 WELCOME

Thank you for purchasing a Zero-X Glyden Drone. The Zero-X Glyden Drone has been specifically designed to provide the intermediate to advanced user with a great flight experience. Please take the time to read the following safety warnings and operating instructions carefully. In this document, the Zero-X Glyden Drone will be referred to as the "Drone".

1.1 BEFORE YOU GET UP IN THE AIR

Before you familiarise yourself with your Zero-X Drone, we ask that you read page "**Battery Safety**" on page 5 before you start charging your Drone's battery.

1.2 GENERAL SAFETY

Before you start using your Drone, please read and familiarise yourself with your local Drone usage legislation. Included in this product's package contents are the Australian CASA guidelines.

Please read this information carefully and only use your Drone within the parameters of your local regulations. Zero-X takes no responsibility for operation of this product.

- **DO NOT** fly your Drone any closer than 30 metres from people, animals or buildings.
- Check to make sure you are no closer than 5.5 kilometres from any airfields or airports. For more information on CASA's Australian legislation visit: <http://www.casa.gov.au/>
- You must not fly your Drone higher than 120 metres above the ground.
- Only fly during the day and keep your Drone within your visual line-of sight.
- For information outside Australia please visit the website of your local aviation authority.
- **DO NOT** attempt to modify the Drone or any of its components in any way, as doing so will void your warranty and may affect the operation of the Drone.
- **DO NOT** use the Drone in any conditions that could affect or damage your Drone. Wind, sand and dust can damage the components of your Drone.
- Please **DO NOT** attempt to touch the Drone when the remote control is on, or while the rotor blades are turning.
- When flying your Drone, please keep in mind the privacy of others.

2.0 PRODUCT CONTENTS

1. Zero-X Glyden Drone
2. Remote Control
3. Rotor Blades x 4
4. Rotor Guards x 4
5. USB AC Wall Charger
6. USB Charging Cables x 2
(One for Drone and another for rechargeable Remote Control)
7. Screwdriver
8. User Manual

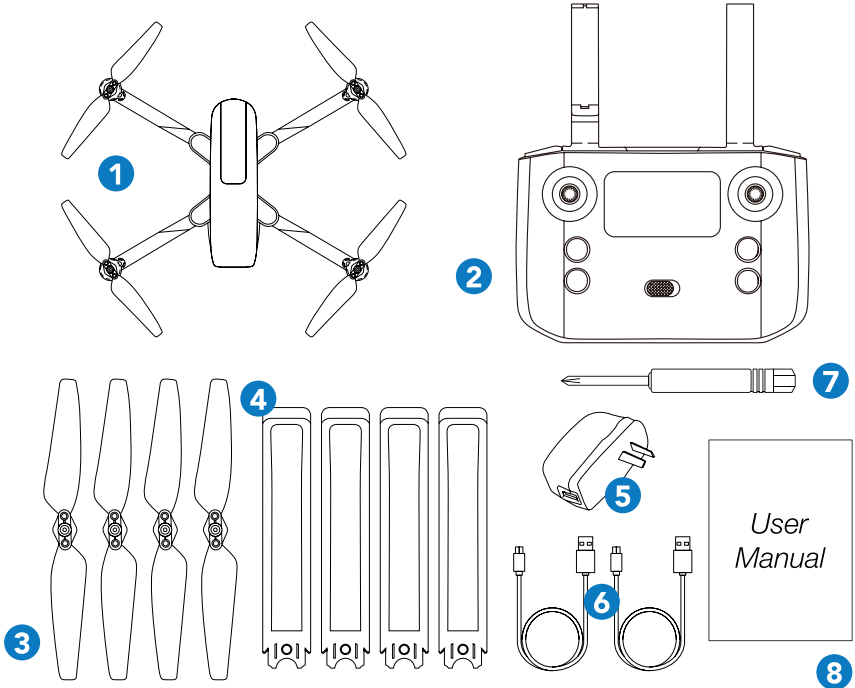

2.1 PRODUCT OVERVIEW

1. Camera
2. Rotor Blades
3. Motor
4. Power Button
5. Battery Release Button

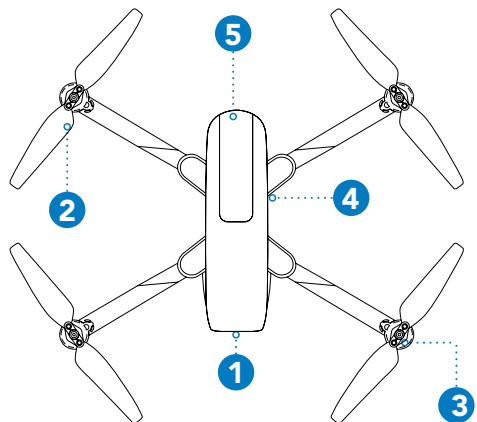

2.2 REMOTE CONTROL OVERVIEW

1. Left Control Stick (Ascend/Descend, Yaw Left/Right)
2. One Key Take Off/Landing
3. Headless Mode
4. On/Off
5. Trim Button
6. Emergency Stop
7. Right Control Stick (Forward/Reverse, Left/Right)
8. 360° Flip
9. Speed
10. Photo/Video
11. Power: Green light
12. Charging : Red light
(The light is red during charging and will go off when the remote control is fully charged)

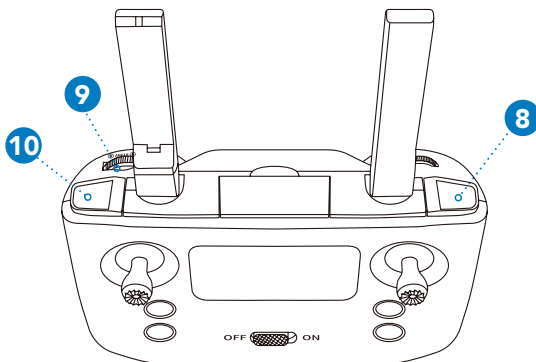
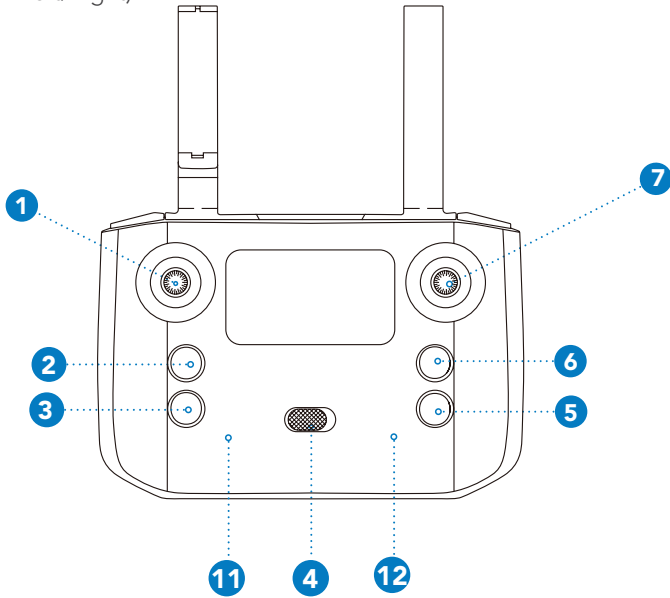

IMPORTANT INFORMATION - PLEASE READ BEFORE USE

3.0 BATTERY SAFETY

When handled incorrectly, Lithium polymer batteries can be dangerous and can potentially harm persons and/or property. Zero-X does not accept any liability for damage to persons and/ or property.

These are our suggestions to keep safe:

- Always unwind all cables before charging.
- **DO NOT** over charge the battery. Once charged, please remove the battery from the charger as soon as possible.
- Only use the included or replacement Zero-X Glyden chargers and batteries.
- You must charge the Lithium polymer battery in a safe area away from flammable materials.
- The battery is only to be charged under adult supervision, do not leave charging batteries unattended. Please keep aware of the charger during the process, and fix any issues or problems may occur.
- **DO NOT** charge the battery in temperatures higher than 40°C or lower than 0°C.
- **DO NOT** cover the batteries when charging or leave them in direct sunlight.
- After each flight and/or crash, please check batteries for any damage or swelling.
- If the battery is damaged, leaking, making noises, punctured or malformed in any way, please **DO NOT** attempt to use it. Please dispose of the battery immediately, correctly and safely.
- **DO NOT** bend, puncture, crush or scratch the Drone's battery. **DO NOT** store batteries in your pockets, on you or in extreme temperatures.
- After flying/discharging the battery you must allow it to cool to ambient/room temperature before recharging.
- If the battery begins to balloon or swell, discontinue charging or discharging immediately. Quickly and safely disconnect the battery, then place it in a safe, open area away from flammable materials to observe it for at least 15 minutes. **Continuing to charge or discharge a battery that has begun to balloon or swell can result in a fire.** A battery that has ballooned or swollen even in a small amount must be removed from service completely.
- Never plug in a battery and leave it to charge unattended overnight.
- Non-compliance with the above warnings may result in the failure of the battery and become dangerous.

PLEASE NOTE: YOUR ZERO-X GLYDEN DRONE COMES WITH A CERTIFIED ZERO-X USB AC CHARGING ADAPTOR FOR 240V CHARGING OF YOUR DRONE BATTERY. USE OF A NON ZERO-X CERTIFIED USB AC CHARGING ADAPTOR WILL VOID YOUR WARRANTY AND MAY DAMAGE BOTH YOUR BATTERY AND DRONE.

- Press the buckle and pull out the battery from the your Drone.
- Connect the Drone battery to the charging cable. The light will glow red to indicate that the battery is charging. The LED on the USB charging cable, will turn off once charging is complete.
- Once the battery is running out of power, the light of drone will start to blink. It is vital that the Drone is flown back to the user, to avoid the Drone losing power mid-flight and becoming lost.
- To maximise your battery life, avoid removing the battery from the charging cable before charging is complete. If you have just finished flying your Drone, please allow the battery to cool down for at least 30 minutes before recharging.
- The Drone battery may take up to 2.5 hours to fully charge. If the battery has been on charge for any longer than 3.5 hours and the indicator on the charging cable is not showing that the battery is charged, please remove the battery from the charger.
- Remove the Drone from the charger as soon as it is fully charged. Overcharging the Drone may damage the battery and reduce flight time.

4.0 SETTING UP YOUR DRONE

4.1 INSTALLING THE BATTERY

For detailed instructions on how to install the battery please follow the steps below.

1. Ensure that the battery is fully charged.
2. Insert the battery into the rear of the Drone in the right direction (the tab on the battery should be facing down).
3. Slide the battery all the way in, until it securely slots into place.
4. Press 'LOCK' to lock the battery to the Drone. Press 'UNLOCK' before taking out the battery.

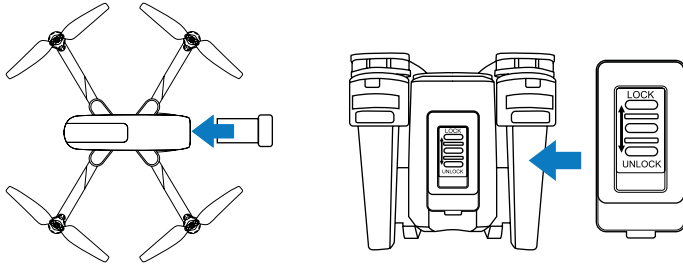

NOTE:

- **DO NOT** force in the battery. If the battery does not fit into position, please check that you have installed the battery in the correct orientation.

4.2 INSTALLING ROTOR GUARDS

Installing the rotor guards is optional. However, installing them will protect your rotor blades and motors against bumps and light crashes.

1. To install the rotor guards, please insert the rotor guard pegs into the designated holes near the motors on the Drone's arms.

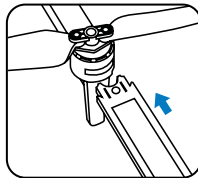

2. To remove the rotor guard, please hold the rotor first, then remove the rotor guard.

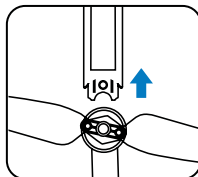

4.3 REMOTE CONTROL

1. The remote control comes with a built-in rechargeable 3.7V 400mAh Li-on battery. When the remote control is low in power, the power indicator light on the remote control will keep on blinking to indicate that it is time to recharge the remote control. Connect the remote control to the charging cable and the light will glow red indicating charging is in process. The power light on the remote control will turn off once charging is complete. The remote control can take up to 45 minutes to fully charge.

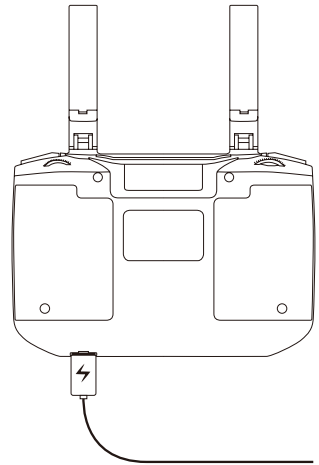

4.4 SYNCING YOUR DRONE

1. Press the **ON/OFF** button on the top of the Drone to turn on the Drone. The LED light of the Drone will blink a green colour (front) and a red colour (rear).
2. Turn on the remote control and it will make a beeping sound and the LED indicator will blink in green.
3. Move the left control stick to the upside for **1 second** and then move the left control stick to the downside for **1 second**. The remote will beep and the LED light of the Drone will stop blinking. The LED will change to a constant green at the front and constant red at the rear. **(Fig 1)**.
4. Please ensure that you have connected the Drone to your smartphone via Wi-Fi before flying the Drone. Please refer to **"Connecting To The Drone Wi-Fi" on page 15**.
5. Place the Drone on a flat surface, and hold the left and right control sticks outward and downward (left stick 7 o'clock and right stick 5 o'clock positions) for **3 seconds**. The indicator on the Drone will change from a constant light to a rapidly blinking light. When the LED light of the Drone remains constant again, this means that the Drone has been calibrated successfully. **(Fig 2)**.

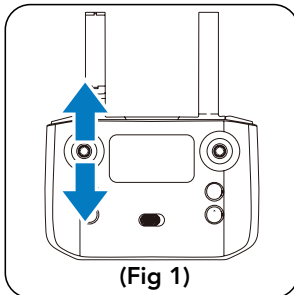

(Fig 1)

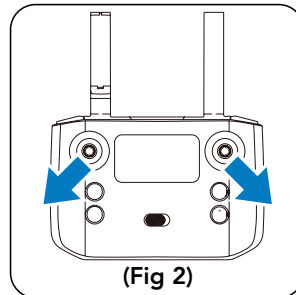

(Fig 2)

NOTE:

- Please repeat Step 5 before every flight.
- Please pair the remote control within 5 metres of the Drone to avoid interference with other signals.

4.5 YOUR DRONE IS READY TO TAKE OFF

Please ensure that the Drone is kept on a flat surface and away from any obstructions.

There are two methods to begin flying your Drone:

1. Press the One Key Take Off/Landing button (**Fig 3**).

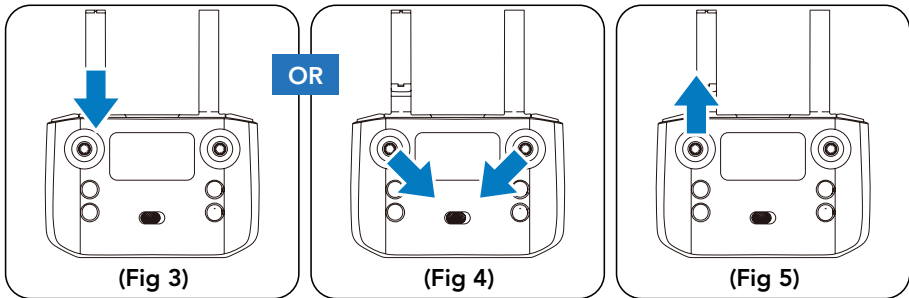

2. Press the left and right control sticks inward and downward (left stick 5 o'clock and right stick 7 o'clock positions) (**Fig 4**) for **3 seconds**. The Drone blades will start rotating and the Drone is ready to fly by pushing the left control stick upwards (**Fig 5**).

5.0 FLYING YOUR DRONE**5.1 5.1 FLIGHT SAFETY**

Before flying your Drone make sure that you are in a safe setting. CASA restrictions regarding flying Drones require the Drone to be no closer than 5.5 kilometres from any airport or airfield while flying. Drones should also not be flown over populated areas or any closer than 30 metres from vehicles, people or animals.

It is also required that you check your surroundings before taking off making sure there are no obstacles or dangers in the area including overhead power lines and large bodies of water. If there are hazards present in your intended area of flight, please consider an alternative location.

5.2 BASIC FLIGHT

UP AND DOWN

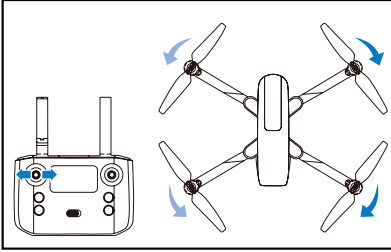

Push the left control stick up to gain altitude and down to descend

FORWARD AND REVERSE

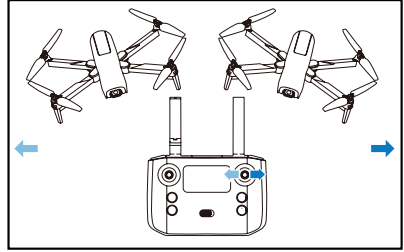

Push the right control stick up and down to fly forward and reverse.

ROTATION

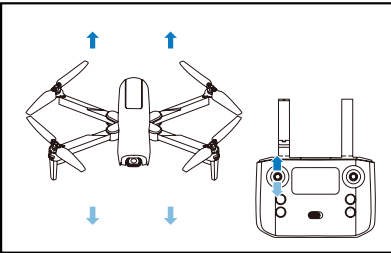

Push the left control stick left and right to pivot left/right.

LEFT/RIGHT FLIGHT

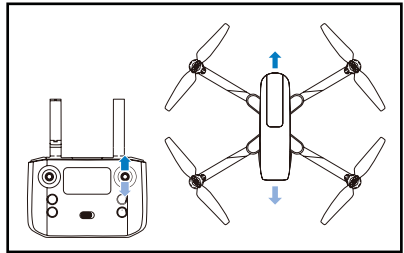

Push the right control stick left and right to fly left/right.

5.3 TRIM FUNCTION

Trimming is used to balance out your Drone if it is drifting when flying. To adjust the Trimming please follow the steps below. **You can only use the Trim function when the Drone is airborne.**

1. Make sure that the remote control and Drone are switched on and correctly paired.
2. Press the trim button and then use the right control stick to activate the trimming function.
3. You can now adjust your trim by using the right control stick to move left/right and/or up/down. Please refer to the images 1-3 below.
4. To stop the trimming function, press the trim button again or stop using the right control stick for 3 seconds. The trimming function will automatically stop.

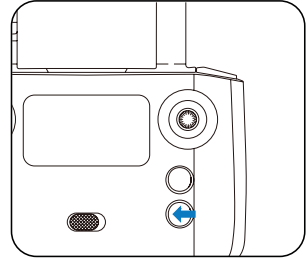

TRIM FORWARD/REVERSE

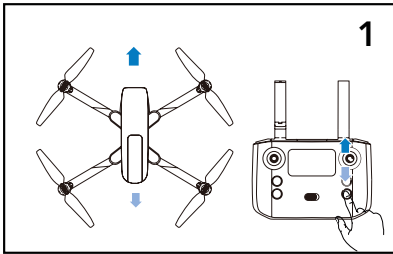

When the Drone is hovering in place, and starts to drift forward, press the right control stick backwards until it is stable. If it drifts backwards, press the right control stick forward until it's stable.

TRIM LEFT/RIGHT FLIGHT

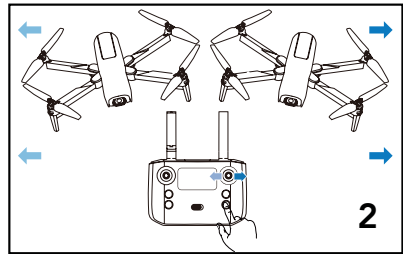

When the Drone is hovering and starts to drift to the side, push the right stick to the left/right until the Drone is stable.

LEFT/RIGHT TRIM

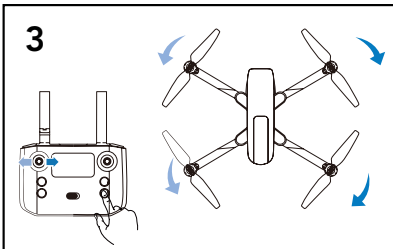

If the Drone keeps rotating to left, press the left control stick to the right until it is stable. If the Drone keeps rotating to the right, press the left control stick to the left until it is stable.

5.4 SPEED MODE

The Drone has 2 speed modes that control the acceleration and maneuverability of the Drone.

To cycle through the speed modes, use the Speed button at the top left of the remote control.

Each mode will be identifiable by a series of beeps.

- **Low Speed Mode (Default):** One beep.
- **Medium Speed Mode:** Two beeps.

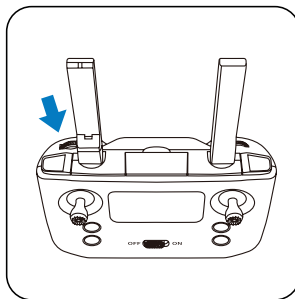

NOTE:

- For beginners it is suggested to operate the Drone at **Low Speed**.

6.0 CAMERA/VIDEO FEATURES

6.1 CAMERA MODE

1. With the Drone turned on and paired, short press the Photo/Video button.
2. The remote control will beep once and the LED lights of the Drone will blink once to indicate that a photo was taken.

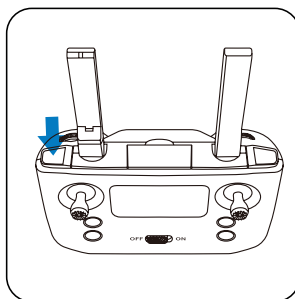

6.2 VIDEO MODE

1. With the Drone turned on and paired, long press the Photo/Video button.
2. The remote control will beep once and the LED light on the Drone will blink continuously to indicate that a video is being recorded.
3. Long press the video button again to stop recording and the LED light of the Drone will blink twice accordingly.

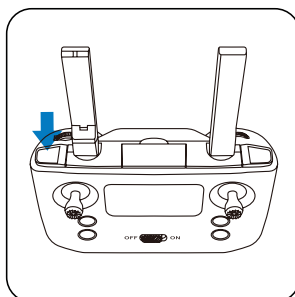

7.0 FLIP FUNCTION

Fly your Drone to a height of more than 3 metres and press the FLIP button at the top right of your remote control. Then immediately push the right control stick to either forward/reverse or left/right position to flip your Drone.

NOTE:

- The Flip function is only available during the first 8 minutes of flight time.

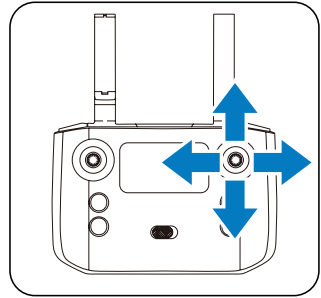
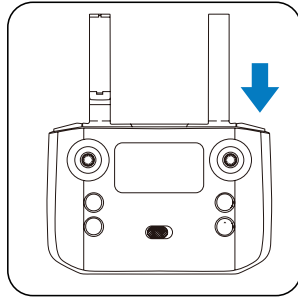

8.0 HEADLESS MODE

When the Headless mode is enabled, the Drone will move in the direction that the control stick is pressed, regardless of its orientation. This makes it easy to bring the Drone home when it is far away from you. To ensure headless mode works well, please use the correct take off position. The camera of the Drone must point in the intended direction of flight; the back of the Drone should be facing the pilot. See instructions below.

1. Press the Headless Mode button on the control (shown in the diagram to the right). The remote control will start beeping continuously and the LED light of drone will blink continuously indicating that headless mode has been enabled. To stop headless mode, press the headless mode button again. The remote control will stop beeping and the LED light of drone will also stop blinking.
2. When using headless mode, the camera of the Drone must point in the direction of flight; the back of the Drone should be facing the operator. See below.

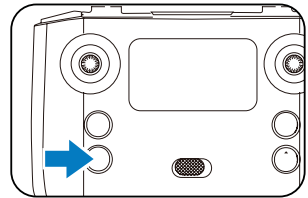

(Fig 6)

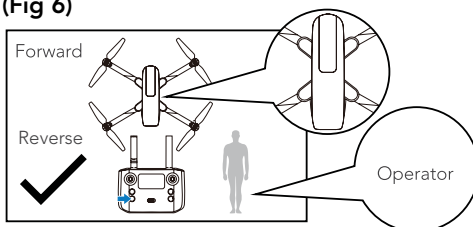

Correct take off position.

(Fig 7)

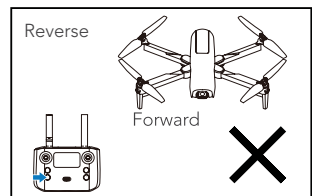

Incorrect take off position.

9.0 EMERGENCY/STOP

To activate an emergency stop while the Drone is airborne, long press the One Key Take Off/Landing button. The rotor blades will lock and the drone will fall to the ground.

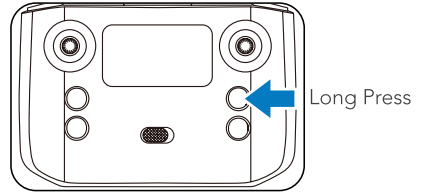

NOTE:

- It is highly recommended that you do not push this button unless it is an emergency.

10.0 OPTICAL FLOW POSITION

The Optical Flow Position enables your Drone to fly stably so that it can take photos and videos with high quality results.

1. For drones with an optical flow function, the drone will come with 2 cameras.
2. The front camera comes with a full 1080p resolution while the bottom camera features a 480p resolution.
3. During flight, the Drone will follow the image from the bottom camera which enables the Drone to fly in a stable position.

NOTE:

- The ground surface under your Drone will need some gradient or variation to it in order for the Drone to recognise the ground and remain stable.

11.0 SAVING VIDEOS AND PHOTOS USING YOUR SMARTPHONE

The Drone uses your connected smartphone to save all videos and photos. This makes reviewing and transferring your Drone footage simple and easy. If you do not have your smartphone connected to the Drone via Wi-Fi during flight, then no footage will be recorded or saved.

12.0 DOWNLOADING THE ZX- FLY APP TO YOUR SMARTPHONE

12.1 WHERE TO DOWNLOAD

For iPhones: Go to the Apple App Store and search for the ZX-FLY App.

For Android phones: Go to the Google Play Store and search for the ZX-FLY App.

12.2 ZX-FLY APP



The Drone has a built-in Wi-Fi connection which is used to wirelessly connect your smartphone to your Drone allowing you to view the Drone camera's live view, trigger recording, and control and fly your Drone.

To connect your smartphone to the Drone please follow the instructions below.

1. Go to the Google Play store if you are using an Android smartphone, or the Apple Store if you are using an iPhone and search for the App named "ZX-FLY". Once it is located, please download and install the App.
2. Alternatively, please scan the QR code to download and install the App.



12.3 CONNECTING TO THE DRONE WI-FI

1. Go to your mobile phone's settings menu and enter the Wi-Fi settings.
2. Turn on your Drone.
3. If your Wi-Fi is turned off, turn it on and search for ZX-GLYDEN_XXXX in the available networks. Select ZX-GLYDEN_XXXX. Once the connection is successful an icon will appear next to it.
4. Once connected, open the ZX-FLY App on your smartphone.

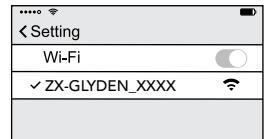

Minimum smartphone Requirements (for use with the ZX-FLY app). iPhone: iPhone 6 or later using iOS 8.0 and above. Samsung Galaxy: S5 and later using Mobile Android 5.0 and above. Minimum 3G Wi-Fi network connection for GPS functionality. Apple, the Apple logo, and iPhone are trademarks of Apple Inc., registered in the U.S. and other countries. Google Play and the Google Play logo are trademarks of Google Inc. Industries.

13.0 DRONE MAINTENANCE

13.1 REPLACING ROTOR BLADES

If your rotor blades become damaged or the Drone is no longer flying straight, the rotor blades may need to be replaced. To replace the Drone's rotor blades, please follow the directions below.

There are two types of rotor blades included with the Drone, **A** blades (clockwise rotation) and **B** blades (counter clockwise rotation). The blades are marked on top showing either **A** or **B**. The arms of the Drone are marked **A** and **B**, showing what blades each motor is compatible with.

It is important that the rotor blades are installed on the designated motors or else the Drone may not fly and you could potentially burn out the Drone's motors.

To remove and replace the rotor blades, please follow the instructions below.

1. Remove the rotor blades by turning the securing screw counter clockwise with the screwdriver (included).
2. Once the screw has been removed gently pull the rotor blade upward to remove the rotor blade from the motor stem.
3. Please ensure you identify and match the correct blade with the motor (**A** rotor blade to **A** motor, **B** rotor blade to **B** motor).
4. Place the new rotor blade over the motor stem and press it to ensure it is locked.
5. Replace and tighten the screw.

NOTE

- It is important that the correct rotor blades are installed on the correct motors. If they are installed incorrectly, then the Drone will not fly and you could burn its motors.
- When replacing multiple rotor blades please replace the blades one at a time to avoid any confusion in re-attaching the rotor blades.

14.0 REPLACEMENT PARTS

We understand that it is not always easy learning how to fly a Drone. In rare occurrences, a 'close call' can turn into a crash landing. Accidents happen!

To thank you for your support of Zero-X and your Drone purchase, we would like to help you build your confidence in learning how to fly your Drone by offering you 50% off your first two orders of spare parts.

Simply make your spare parts purchase via our website and use the codes in the coupons to redeem and use your discount.

Happy flying!

Visit www.zero-x.com.au | www.zero-x.co.nz to make your purchase.

ZX-DR2BATT
ZX-DR2MOCCW
ZX-DR2MOCW
ZX-DR2RBS
ZX-DR2RGS
ZX-DR2USBCBL

ZERO-X ADDITIONAL BATTERY PACK FOR 1080P FHD, 16 MINUTES
ZERO-X DR2 SPARE PART COUNTER CLOCKWISE MOTOR*2
ZERO-X DR2 SPARE PART CLOCKWISE MOTOR*2
ZERO-X DR2 SPARE PART ROTOR BLADES*4
ZERO-X DR2 SPARE PART ROTOR GUARDS*4
ZERO-X DR2 SPARE PART USB CABLE



15.0 WARRANTY TERMS AND CONDITIONS

Our goods come with guarantees that cannot be excluded under the Australian Consumer Law. You are entitled to a replacement or refund for a major failure and for compensation for any other reasonably foreseeable loss or damage. You are also entitled to have the goods repaired or replaced if the goods fail to be of acceptable quality and the failure does not amount to a major failure.

This warranty is provided in addition to your rights under the Australian Consumer Law. Directed Electronics Australia Pty Ltd (Directed Electronics) warrants that this product is free from defects in material and workmanship for a period of 12 months from the date of purchase or for the period stated on the packaging. This warranty is only valid where you have used the product in accordance with any recommendations or instructions provided by Directed Electronics.

This warranty excludes defects resulting from alterations of the product, accident, misuse, abuse or neglect. In order to claim the warranty, you must return the product to the retailer from which it was purchased or if that retailer is part of a National network, a store within that chain, along with satisfactory proof of purchase. The retailer will then return the goods to Directed Electronics.

Directed Electronics will repair, replace or refurbish the product at its discretion. The retailer will contact you when the product is ready for collection. All costs involved in claiming this warranty, including the cost of the retailer sending the product to Directed Electronics, will be borne by you.

Email: admin@zero-x.com.au

INDEMNITY

You agree to defend, indemnify and hold harmless Zero-X and its subsidiaries and affiliates from and against any and all claims, proceedings, injuries, liabilities, losses, costs and expenses (including reasonable legal fees), including but not limited to, claims alleging negligence, invasion of privacy, copyright infringement and/or trademark infringement against Zero-X and its subsidiaries and affiliates, relating to or arising out of your breach of any provision of these terms, your misuse of Zero-X products or its services, or your unauthorized modification or alteration of products or software.

WARRANTY AND WARRANTY DISCLAIMER

Zero-X has a limited warranty, whereby Zero-X warrants to you and only to you that this Zero-X product will be free from defects in materials and workmanship for one (1) year from the date of your purchase (unless a longer warranty period is required by law). The specifics of this Zero-X limited warranty are covered in this manual.

To the extent possible under governing law, other than the above product warranty for the Zero-X product you understand and agree that the Zero-X services are provided on an “as is” and “as available” basis.

Zero-X makes no warranty that the Zero-X product and services will meet your requirements or that use of the Zero-X services will be uninterrupted, timely, secure or error-free. Nor does Zero-X make any warranty as to the accuracy or reliability of any information obtained through Zero-X (including third party content), that any defects in the Zero-X products or services be corrected or that the Zero-X products or Zero-X services will be compatible with any other specific hardware or service.

Further, Zero-X does not warrant that Zero-X products or services or Zero-X servers that provide you with data and content are free of viruses or other harmful components.

Zero-X also assumes no responsibility for and shall not be liable, for any damages caused by viruses that may infect your Zero-X. In the event of any loss, damage or injury, you will not look to Zero-X to compensate you or anyone else. You release and waive for yourself and your insurer all subrogation and other rights to recover against Zero-X arising as a result of the payment of any claim for loss, damage or injury.

Zero-X equipment and services do not cause and cannot eliminate occurrences of certain events, including, and Zero-X makes no guarantee or warranty, including any implied warranty of merchantability or fitness for a particular purpose, that the Zero-X equipment and services provided will detect or avert such incidents or their consequences.

Zero-X does not undertake any risk that you or property, or the person or property of others, may be subject to injury or loss if such an event occurs. The allocation of such risk remains with you, not Zero-X.

Other than the above product warranty for the Zero-X products, its suppliers disclaim all warranties of any kind, whether express, implied, or statutory, regarding the Zero-X services, including any implied warranty of title, merchantability, fitness for a particular purpose, or non-infringement of third party rights.

Because some jurisdictions do not permit the exclusion of implied warranties, the last sentence of this section may not apply to you.

Zero-X hereby further expressly disclaims all liability for any claims for service failures that are due to normal product wear, product misuse, abuse, product modification, improper product selection or your non-compliance with all applicable federal, state or local laws.

This warranty and warranty disclaimer give you specific legal rights, and you may have other rights that vary by state, province, or country. Other than as permitted by law, Zero-X does not exclude, limit or suspend other rights you have, including those that may arise from the nonconformity of a sales contract.

For a full understanding of your rights, you should consult the laws of your state, province, or country. For our Australian customers: Please note that this warranty is in addition to any statutory rights in Australia in relation to your goods which, pursuant to the Australian Consumer Law, cannot be excluded.

LIMITATIONS OF ZERO-X LIABILITY

Under no circumstances will Zero-X be liable in any way for any content, including, but not limited to, the loss of content, any errors or omissions in any content, or any loss or damage of any kind incurred in connection with use of or exposure to any content posted, emailed, accessed, transmitted, or otherwise made available via Zero-X.

Zero-X liability for damages, especially for breach of duty or obligation, delay in performance, non-performance, or malperformance shall be precluded, except when these are due to negligent breaches of any significant contractual duty or obligation on the part of Zero-X. Any liability for negligence is limited to direct losses usually and typically foreseeable in such case. Should the claim for damages be based on willful or grossly negligent breach of contractual duty or obligation on the part of Zero-X, the preclusion and limitation of liability mentioned in the preceding sentences will not apply. The preceding preclusion and limitation of liability will also not apply to claims for damages arising out of loss of life, bodily injury or health impacts for which Zero-X may be liable, or for non-contractual liability.

Some states and countries do not allow the exclusion or limitation of incidental or consequential damages, so the above limitation or exclusion may not apply to you. Additionally, this provision is not intended to limit Zero-X's liability in the event of Zero-X's willful or intentional misconduct.

Capture the skies.™



www.zero-x.com.au | www.zero-x.co.nz



All Images, Information and Content are
Copyright © 2023 Directed Electronics
Australia Pty Ltd. All Rights Reserved.

www.directed.com.au | www.directed.co.nz

© Zero-X v1.0 2022