

# alto

FULL HD Drone with Optical Flow & WIFI FPV

## USER MANUAL



ZERO-X<sup>®</sup>

ZXM-D200

v1

## ZERO-X IS A PROUD DRONE SAFETY ADVOCATE



### Test your knowledge at [knowyourdrone.gov.au](https://knowyourdrone.gov.au)

Be aware of local legislations and read the instructions carefully before using your drone. Keep yourself and others safe when flying your Zero-X drone. Always fly your drone within visual line-of-sight and only fly one drone at a time. Do not allow your view of the drone to be impaired eg: in rain, wind, snow, fog or low light. When flying your drone, please keep in mind the safety and privacy of others.

Do not get your drone wet, dusty or sandy. Do not touch your drone while it is powered on and when the rotor blades are turning.

For replacement parts batteries, blades, and accessories please visit your nearest Zero-X retailer or visit [www.zero-x.com.au](https://www.zero-x.com.au) | [www.zero-x.co.nz](https://www.zero-x.co.nz)

# CONTENTS

<b>1.0 WELCOME</b> .....	<b>2</b>
1.1 BEFORE YOU GET UP IN THE AIR.....	2
1.2 GENERAL SAFETY.....	2
<b>2.0 PRODUCT CONTENTS</b> .....	<b>3</b>
2.1 PRODUCT OVERVIEW.....	3
2.2 CONTROLLER OVERVIEW.....	4
<b>3.0 BATTERY SAFETY</b> .....	<b>5</b>
<b>4.0 SETTING UP YOUR DRONE</b> .....	<b>7</b>
4.1 INSTALLING THE BATTERY.....	7
4.2 INSTALLING ROTOR GUARDS.....	7
4.3 REMOTE CONTROL.....	8
4.4 SYNCING YOUR DRONE.....	8
4.5 YOUR DRONE IS READY TO TAKE OFF.....	9
<b>5.0 FLYING YOUR DRONE</b> .....	<b>10</b>
5.1 FLIGHT SAFETY.....	10
5.2 BASIC FLIGHT.....	10
5.3 TRIM FUNCTION.....	11
5.4 SPEED MODE.....	12
<b>6.0 CAMERA / VIDEO FEATURES</b> .....	<b>12</b>
6.1 CAMERA MODE.....	12
6.2 VIDEO MODE.....	12
<b>7.0 FLIP FUNCTION</b> .....	<b>13</b>
<b>8.0 HEADLESS MODE</b> .....	<b>13</b>
<b>9.0 ONE KEY REVERSE</b> .....	<b>14</b>
<b>10.0 EMERGENCY / STOP</b> .....	<b>14</b>
<b>11.0 OPTICAL FLOW POSITION</b> .....	<b>14</b>
<b>12.0 SAVING VIDEOS &amp; PHOTOS USING YOUR SMARTPHONE</b> .....	<b>14</b>
<b>13.0 DOWNLOADING THE ZERO-X SWIFT+ APP TO YOUR SMARTPHONE</b> ....	<b>15</b>
13.1 WHERE TO DOWNLOAD.....	15
13.2 ZERO-X SWIFT+ APP.....	15
13.3 CONNECTING TO THE DRONE WIFI.....	15
<b>14.0 DRONE MAINTENANCE</b> .....	<b>16</b>
14.1 REPLACING ROTOR BLADES.....	16
<b>15.0 REPLACEMENT PARTS</b> .....	<b>17</b>
<b>16.0 WARRANTY TERMS &amp; CONDITIONS</b> .....	<b>18</b>

## 1.0 WELCOME

Thank you for purchasing a Zero-X Alto Drone. The Zero-X range has been specifically designed to provide the intermediate to advanced user with a great flight experience. Please take the time to read the following safety warnings and operating instructions carefully. In this document, the Zero-X Alto Drone will be referred to as the "Drone".

### 1.1 BEFORE YOU GET UP IN THE AIR

Before you familiarise yourself with your Zero-X Drone, we ask that you read page "**Battery Safety**" on page 5 before you start charging your Drone's battery.

### 1.2 GENERAL SAFETY

Before you start using your Drone, please read and familiarise yourself with your local Drone useage legislation.

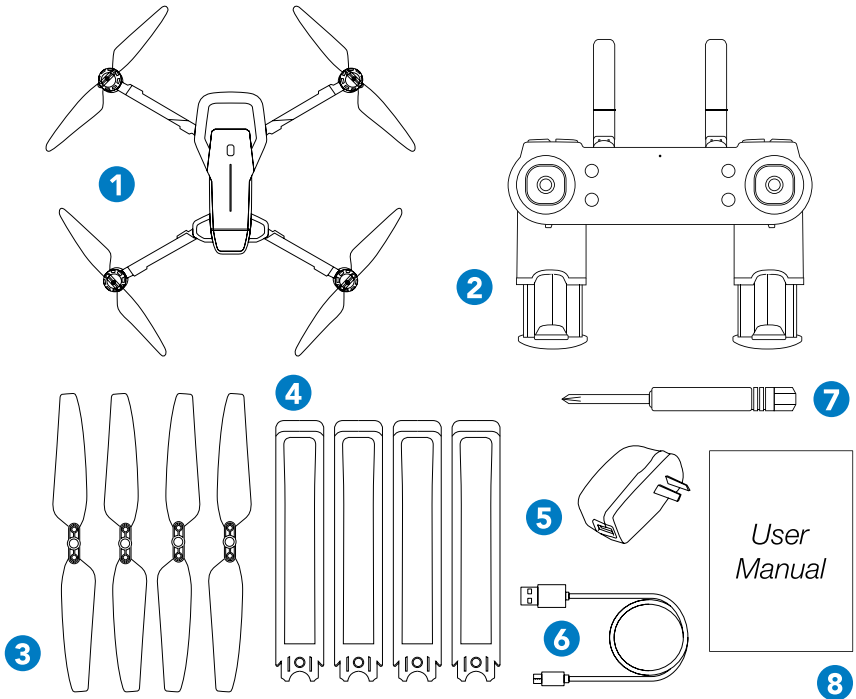
Included in this product's package contents are the Australian CASA guidelines.

Please read this information carefully and only use your Drone within the parametres of your local regulations. Zero-X takes no responsibility for operation of this product.

- **DO NOT** fly your Drone any closer than 30 metres from people, animals or buildings.
- Check to make sure you are no closer than 5.5 kilometres from any airfields or airports. For more information on CASA's Australian legislation visit: <http://www.casa.gov.au/>
- You must not fly your Drone higher than 120 metres (400 ft) above the ground.
- Only fly during the day and keep your Drone within your line-of sight.
- For information outside Australia please visit the website of your local aviation authority.
- **DO NOT** attempt to modify the Drone or any of its components in any way, as doing so will void your warranty and may affect the operation of the Drone.
- **DO NOT** use the Drone in any conditions that could affect or damage your Drone. Wind, sand and dust can damage the components of your Drone.
- Please **DO NOT** attempt to touch the Drone when the remote control is on, or while the rotor blades are turning.
- When flying your Drone, please keep in mind the privacy of others.

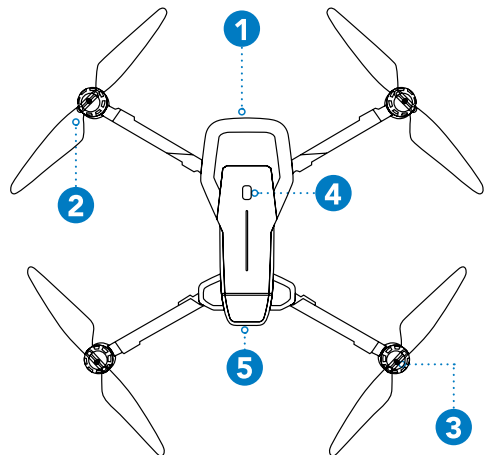
## 2.0 PRODUCT CONTENTS

1. Zero-X Alto Drone
2. Remote Control
3. Rotor Blades x 4
4. Rotor Guards x 4
5. USB AC Wall Charger
6. USB Charging Cable
7. Screw Driver
8. User Manual



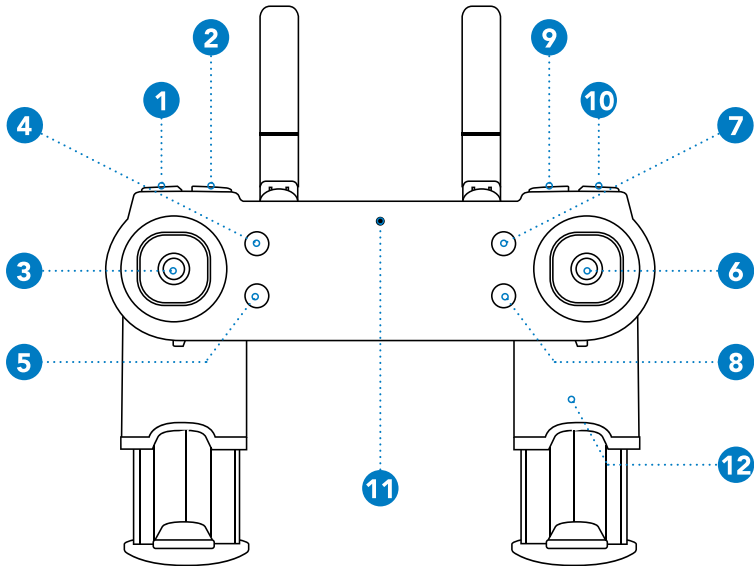
## 2.1 PRODUCT OVERVIEW

1. Camera
2. Rotor Blades
3. Motor
4. Power Button
5. Battery Release Button



## 2.2 CONTROLLER OVERVIEW

1. Speed
2. Reverse
3. Left Control Stick (Pulse / Descend, Yaw Left / Right)
4. One Key Take Off / Landing
5. Emergency Stop
6. Right Control Stick (Forward / Backward, Left / Right)
7. Photo
8. Video
9. Headless Mode
10. 360° Flip
11. LED Power ON
12. ON / OFF



## IMPORTANT INFORMATION - PLEASE READ BEFORE USE

### 3.0 BATTERY SAFETY

When handled incorrectly, Lithium polymer batteries can be dangerous and can potentially harm persons and / or property. Zero-X does not accept any liability for damage to persons and/ or property.

#### **These are our suggestions to keep safe:**

- Always unwind all cables before charging.
- **DO NOT** over charge the battery. Once the charging process is completed, remove the battery from the charger.
- Only use the included or replacement Zero-X Alto Drone chargers and batteries.
- You must charge the Lithium polymer battery in a safe area away from flammable materials.
- The battery is only to be charged under adult supervision, **DO NOT** leave charging batteries unattended.
- Please keep aware of the charger during the process, and fix any issues or problems may occur.
- **DO NOT** charge the battery in temperatures hotter than 40°C or colder than 0°C.
- **DO NOT** cover the batteries when charging. **DO NOT** leave batteries in direct sunlight.
- After each flight and / or crash, please check battery for any damage or swelling.
- If the battery is damaged, leaking, making noise, punctured or malformed in any way **DO NOT** attempt to use it. Please dispose of the battery immediately and safely in the correct manner.
- **DO NOT** bend, puncture, crush or scratch the Drone's battery. **DO NOT** store batteries in your pockets, on your person or in extreme temperatures.
- After flying/discharging the battery you must allow it to cool to ambient/room temperature before recharging.
- Stop charging the battery if it begins to balloon or swell and quickly. Place it in a safe, open area away from flammable materials to observe it for at least 15 minutes. **Continuing to charge or discharge a battery that has begun to balloon or swell can result in a fire.** A battery that has ballooned or swollen even a small amount must be removed from Drone completely.
- Never plug in a battery and leave it to charge unattended overnight.
- Non-compliance with the above warnings may result in the failure of the battery and become dangerous.

**PLEASE NOTE: YOUR ZERO-X ALTO DRONE COMES WITH A CERTIFIED ZERO-X USB AC CHARGING ADAPTER FOR 240v CHARGING OF YOUR DRONE BATTERY. USE OF A NON ZERO-X CERTIFIED USB AC CHARGING ADAPTER WILL VOID YOUR WARRANTY AND MAY DAMAGE BOTH YOUR BATTERY AND DRONE.**

- Press the buckle and pull out the battery from the your Drone.
- Connect the Drone battery to the charging cable. The light will glow red to indicate that the battery is charging. The LED on the USB charging cable, will turn off once charging is complete.
- Once the battery is running out of power, the lights of the drone will start flashing. It's vital that the Drone is flown back to the user, to avoid the Drone losing power mid-flight and becoming lost.
- To maximise your battery life, avoid removing the battery from the charging cable before charging is complete. If you have just finished flying your Drone, please allow the battery to cool down for at least 30 minutes before recharging.
- The Drone battery may take up to 2.5 hours to charge. If the battery has been on charge for any longer than 3.5 hours and the indicator on the charging cable is not showing that the battery is charged, please remove the battery from the charger.
- Remove the Drone from the charger as soon as it is fully charged. Overcharging the Drone may damage the battery and reduce flight time.

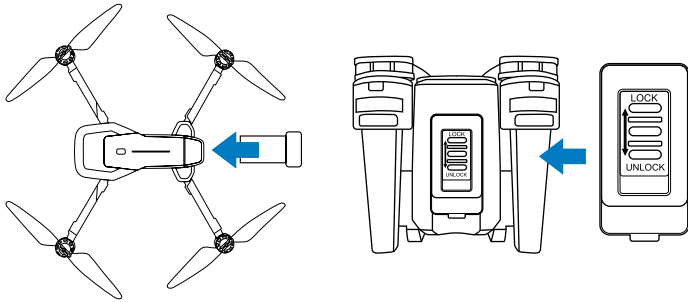


## 4.0 SETTING UP YOUR DRONE

### 4.1 INSTALLING THE BATTERY

For detailed instructions on how to install the battery please follow the steps below:

1. Ensure that the battery is fully charged.
2. Insert the battery into the rear of the Drone in the right direction (the tab on the battery should be facing down).
3. Slide the battery all the way in, until it securely slots into place.
4. Press '**LOCK**' to lock the battery with drone. Press '**UNLOCK**' before taking out the battery.



#### NOTE:

- **DO NOT** force the battery. If the battery does not fit into position, please check that you have battery in the right way.

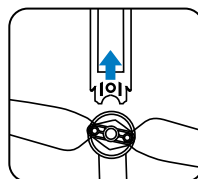
### 4.2 INSTALLING ROTOR GUARDS

Installing the rotor guards is optional, however installing them will protect your rotor blades and motors against bumps and light crashes.

1. To install the rotor guards please insert the rotor guard pegs into the designated holes near the motors on the Drone's arms.

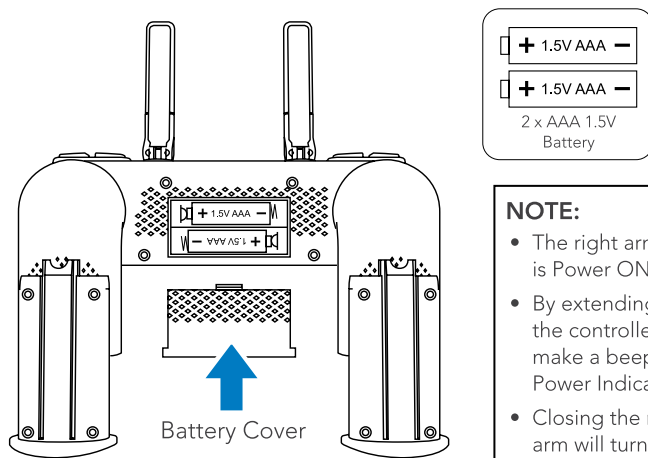


2. To remove the rotor guard, please hold the rotor first, then remove the rotor guard.



### 4.3 REMOTE CONTROL

1. Extend the arms of the remote control.
2. Remove the battery cover on the rear of the remote control by sliding it downward.
3. Insert 2 x AAA batteries (AAA batteries not included) making sure that they are in the orientation specified.

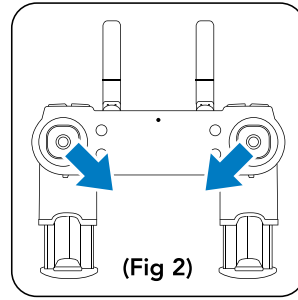
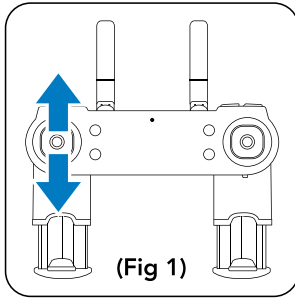


#### NOTE:

- The right arm of the controller is Power ON / OFF.
- By extending the arm lower, the controller will Power On, make a beep sound and the Power Indicator will turn ON.
- Closing the right controller arm will turn off the controller.

### 4.4 SYNCING YOUR DRONE

1. Press the ON/OFF button on the top of the Drone to turn the Drone on, the LED light of the Drone will blink a green colour (front) and a red colour (rear).
2. Extend the arms of the controller downwards, the controller will make a beeping sound and the LED indicator will Power On the controller.
3. Move the left control stick to the upside for **1 second** and then move the left control stick to the downside for **1 second**, the controller will beep and the LED light of the drone will stop blinking. The LED will change to solid green in the front and solid red in the rear (**Fig 1**).
4. Please ensure that you have connected your drone to your smartphone via WiFi before flying. Please refer to '**Connecting to the drone WiFi**' on **page 15**.
5. Place the drone on a flat surface, and hold the left and right control sticks inward & downward (left stick 5 o'clock and right stick 7 o'clock positions) for **3 seconds**. The indicator on the drone will change from constant light to quick flashing lights. When the drone has been calibrated successfully the LED lights on the drone remain solid again (**Fig 2**).



**NOTE:**

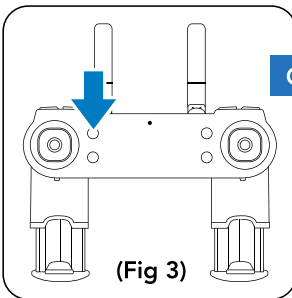
- Please repeat step 5 before every flight.
- Please pair the controller frequency within 5m of the drone to avoid interference with other signals

#### 4.5 YOUR DRONE IS READY TO TAKE OFF

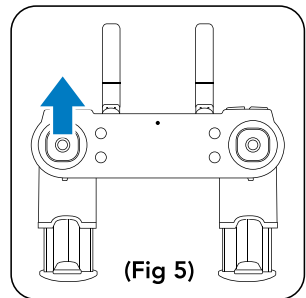
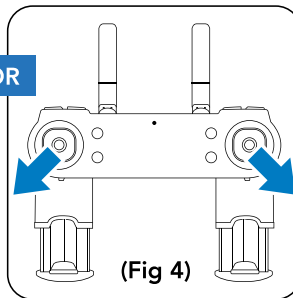
Please ensure that the drone is kept on a flat surface and away from any obstructions.

There are 2 methods to begin flying your drone:

1. Press the **ONE KEY TAKE OFF / LANDING** button (**Fig 3**).
2. Press the left and right control sticks outward and downward (left stick 7 o'clock and right stick 5 o'clock positions) (**Fig 4**) for **3 seconds**. The drone blades will start rotating and the drone is ready to fly by pushing the left control stick upwards (**Fig 5**).



OR



## 5.0 FLYING YOUR DRONE

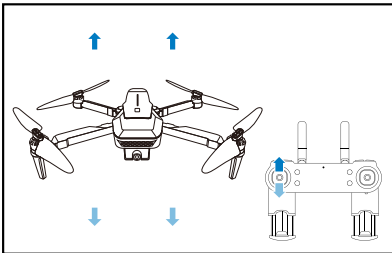
### 5.1 FLIGHT SAFETY

Before flying your Drone make sure that you are in a safe setting. CASA restrictions regarding flying Drones require the Drone to be no closer than 5.5kms from any airport or airfield while flying. Drones should also not be flown over populated areas or any closer than 30 metres from vehicles, people or animals.

It is also required that you check your surroundings before taking off making sure there are no obstacles or dangers in the area including overhead power lines and large bodies of water. If there are hazards present in your intended area of flight, please consider an alternative location.

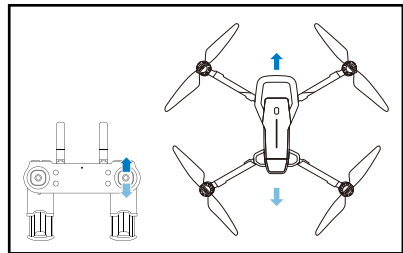
### 5.2 BASIC FLIGHT

#### UP AND DOWN



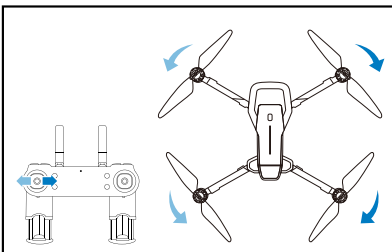
Push the left control stick up to gain altitude and down to descend

#### FORWARD AND BACKWARDS



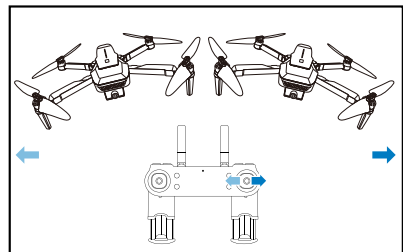
Push the right control stick up and down to fly forward and backwards.

#### ROTATION



Push the left control stick left and right to pivot left/right.

#### LEFT / RIGHT FLIGHT

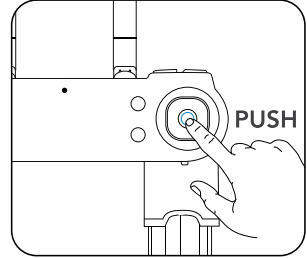


Push the right control stick left and right, to fly left/right.

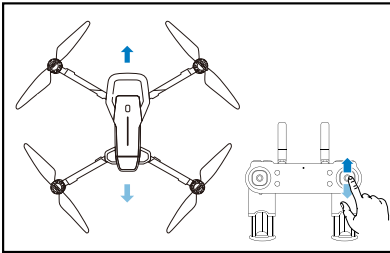
### 5.3 TRIM FUNCTION

Trimming is used to balance out your Drone if it is drifting when flying. To adjust the trimming please follow the steps below. You can only use this trim function when Drone is airborne.

1. Make sure that the Remote Control and Drone are switched on and correctly paired.
2. With the right control stick centered, push down on it, once you hear the stick button click, release it. (This needs to be done each time you want to adjust trim in flight).
3. You can now adjust your trim using your left/right and up/down on your right controller stick. Please refer to the images 1-3 below.
4. To stop Trimming, press down on the right control stick again.

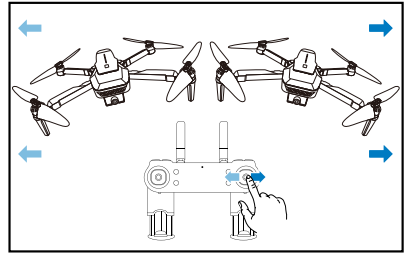


#### TRIM FORWARD / BACKWARD



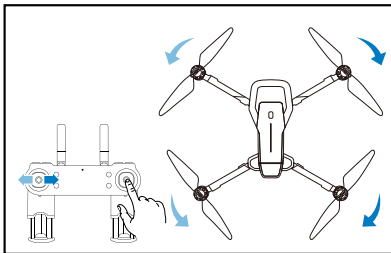
When the Drone is hovering in place, and starts to drift forward, press the right control stick backwards until it's stable. If it drifts backwards, press the right control stick forward until it's stable.

#### TRIM LEFT / RIGHT FLIGHT



When the Drone is hovering and starts to drift to the side, push the right stick to the left/right until the Drone is stable.

#### LEFT / RIGHT TRIM



If the Drone keeps rotating to left, press the left direction stick to the right until it's stable. If the Drone keeps rotating to the right, press the left thumb stick to the left until it's stable.

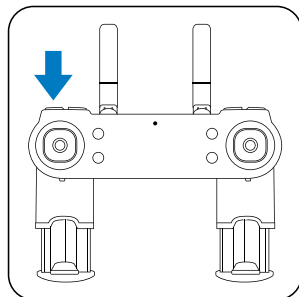
## 5.4 SPEED MODE

The Drone has 3 speed modes.

To cycle through the Speed Modes, use the speed button on the top left of the controller.

Each mode will be identifiable by a series of beeps.

- **Low Speed Mode (Default):**  
One beep.
- **Medium Speed Mode:** Two beeps.
- **High Speed Mode:** Three beeps.



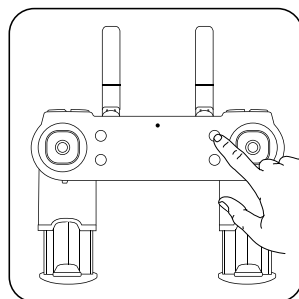
### NOTE:

- For beginners it is suggested to operate the Drone at Low Speed.

## 6.0 CAMERA / VIDEO FEATURES

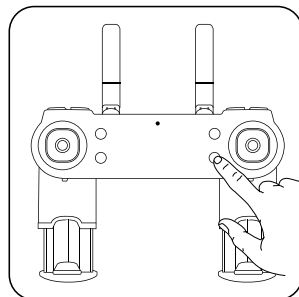
### 6.1 CAMERA MODE

1. With the Drone turned on and paired, press the Photo button.
2. The remote control will beep once and the LED lights of the Drone will blink once to indicate that a photo was taken.



### 6.2 VIDEO MODE

1. With the Drone turned on and paired, press the Video button.
2. The remote control will beep once and the LED lights on the Drone will blink continuously to indicate that a video is being recorded.
3. Press the video button again to stop recording and the LED light on top camera of the Drone will stop blinking.

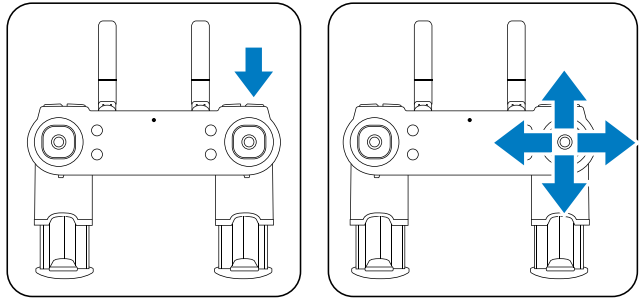


## 7.0 FLIP FUNCTION

Fly your Drone to a height of more than 3 metres and press the FLIP button on the top right of your controller. Then immediately push the right controller stick to either the left or right position to flip your Drone.

**NOTE:**

- The Flip function is only available during the first 8 minutes of flight time.

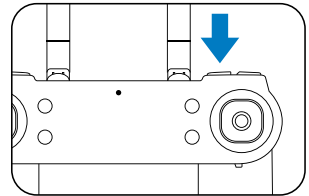


## 8.0 HEADLESS MODE

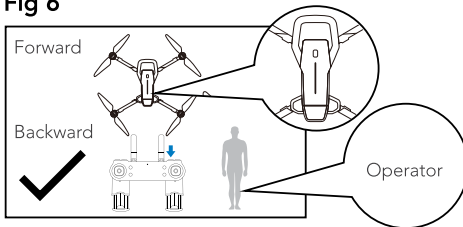
When headless mode is enabled, the Drone will move in the direction that the remote controller stick is pressed, regardless of orientation. This makes it easy to bring the Drone home when it's far away from you.

To ensure headless mode works well, please use the correct take off position. The camera of the Drone must face the intended direction of flight; the back of the Drone would be facing you. See instructions below.

1. Press the HEADLESS MODE button on the controller (shown in the diagram to the right). The remote control will start beeping once indicating that headless mode has been enabled. To stop headless mode, press the headless mode button again; the controller will beep again.
2. When using headless mode, the camera of the Drone must point in the direction of flight; the back of the Drone should be facing the operator. See below.

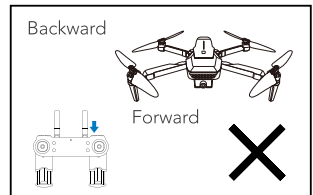


**Fig 6**



Correct take off position.

**Fig 7**

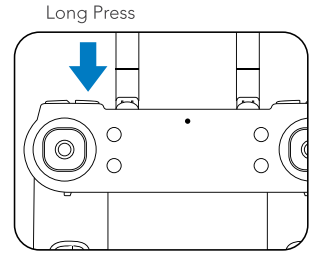


Incorrect take off position.

## 9.0 ONE KEY REVERSE

To ensure One Key Reverse works as intended, please use correct take off position as mentioned in images above.

1. While the Drone is in flight, press the **ONE KEY REVERSE** button on remote control, the controller will beep once and the Drone will fly in reverse.
2. Press the **ONE KEY REVERSE** button again to cancel or push the right control stick in any direction to stop this function.

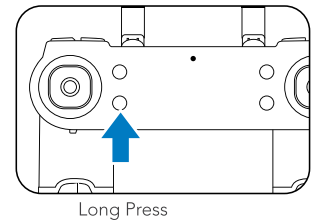


### NOTE:

- It is highly recommended that you push the reverse button only when you are aware that it is safe to reverse.

## 10.0 EMERGENCY / STOP

1. While Drone is Airborne and emergency is activated, the rotor blades will lock and the Drone will fall to the ground.



### NOTE:

- It is highly recommended that you do not push this button unless it is an emergency.

## 11.0 OPTICAL FLOW POSITION

Optical flow position is a way to keep your Drone flying stable, which ensures the Drone takes pictures /video in high quality.

1. For drones with an optical flow function, the drone will come with 2 cameras.
2. One is the front camera with full 1080P, the other is a bottom camera with 480P resolution.
3. During flight the drone will follow the image from the bottom camera which functions to make the Drone fly stable.

### NOTE:

- The ground surface under your drone will need some gradient or variation to it in order for the drone to recognise the ground and remain stable.

## 12.0 SAVING VIDEOS & PHOTOS USING YOUR SMARTPHONE

The Drone uses your connected smartphone to save all videos and photos. This makes reviewing and transferring your Drone footage simple and easy. If you don't have your smartphone connected via WIFI during flight, then no footage will be recorded or saved.



## 13.0 DOWNLOADING THE ZERO-X SWIFT+ APP TO YOUR SMARTPHONE

### 13.1 WHERE TO DOWNLOAD

**For iPhones:** Go to the Apple App Store and search for the ZX-SWIFT+ APP.

**For Android phones:** Go to the Google Play Store and search for the ZX-SWIFT+ APP.

### 13.2 ZERO-X SWIFT+ APP




The Drone has a built in WIFI connection which is used to wirelessly connect your Smartphone to your Drone allowing you to view the Drone camera's live view, trigger recording, control and fly your Drone.

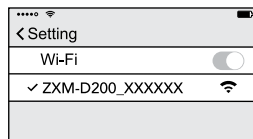
To connect your Smartphone to the Drone please follow the instructions below.

1. Go to the Google Play store if you are using an Android Smartphone, or the Apple Store if you are using an iPhone and search for the App named "ZERO-X SWIFT+", once located please download and install the App.
2. Alternatively, please scan the QR code to download and install the App.



### 13.3 CONNECTING TO THE DRONE WIFI

1. Go to your mobile phone's settings menu and enter the WiFi settings.
2. Turn on your Drone.
3. If your WiFi is turned off, turn it on and search for ZXM-D200\_XXXXXXX in the available networks. Select ZXM-D200\_XXXXXXX, once the connection is successful a  icon will appear next to it.
4. Once connected, open the ZERO-X SWIFT+ APP on your smart phone.



*Minimum Smartphone Requirements (for use of the ZERO-X SWIFT+ APP). iPhone: iPhone 6 or later using iOS 8.0 and above. Samsung Galaxy: S5 and later using Mobile Android 5.0 and above. Minimum 3G network connection for GPS functionality. Apple, the Apple logo, and iPhone are trademarks of Apple Inc., registered in the U.S. and other countries. Google Play and the Google Play logo are trademarks of Google Inc. Industries.*

## 14.0 DRONE MAINTENANCE

Avoid exposing your Drone and its accessories to dust, sand and moisture as these can damage the Drone. If the Drone is exposed to dust or sand, use a soft brush to remove any visible particles.

### 14.1 REPLACING ROTOR BLADES

If your rotor blades become damaged or the Drone is no longer flying straight, the rotor blades may need to be replaced. To replace the Drone's rotor blades please follow the directions below.

There are two types of rotor blades included with the Drone, **A** blades (clockwise rotation) and **B** blades (counter clockwise rotation). The blades are marked on top showing either **A** or **B**. The arms of the Drone are also marked **A** and **B** showing what blades each motor is compatible with.

It is important that the rotor blades are installed on the designated motors or else the Drone may not fly and you could potentially burn out the Drone's motors.

To remove and replace the rotor blades, please follow the instructions below.

1. Remove the rotor blades' securing screw, by unscrewing it counter clockwise with screw driver (included).
2. Once the screw has been removed gently pull the rotor blade upward to remove the rotor blade from the motor stem.
3. Please ensure you identify and match the correct blade with the motor (**A** rotor blade to **A** motor, **B** rotor blade to **B** motor).
4. Place the new rotor blade over the motor stem and press it to ensure it is locked.
5. Replace and tighten the screw.

#### NOTE

- It is important that the correct rotor blades are installed on the correct motors. If they are installed incorrectly, then the Drone will not fly and you could burn its motors.
- When replacing multiple rotor blades, please replace the blades one at a time to avoid any confusion in reattaching the rotor blades.

## 15.0 REPLACEMENT PARTS

We understand that it's not always easy learning how to fly a Drone. In rare occurrences, a 'close call' can turn into a crash landing. Accidents happen!

To thank you for your support of Zero-X and your Drone purchase, we would like to help you build your confidence in learning how to fly your Drone by offering you 50% off your first two orders of spare parts.

Simply make your spare parts purchase via our website and use the codes in the coupons below to redeem and use your discount.

Happy flying!

There you will be able to find and buy the spare parts listed below:

Visit [www.zero-x.com.au](http://www.zero-x.com.au) | [www.zero-x.co.nz](http://www.zero-x.co.nz) to make your purchase.

**ZXM-D200BAT650**  
**ZXM-D200MOCCW**  
**ZXM-D200MOCW**  
**ZXM-D200RBS**  
**ZXM-D200RGS**  
**ZXM-D200USCBL**

REPLACEMENT BATTERY PACK  
SPARE PART COUNTER CLOCKWISE MOTOR x2  
SPARE PART CLOCKWISE MOTOR x2  
SPARE PART ROTOR BLADES x4  
SPARE PART ROTOR GUARDS x4  
SPARE PART USB CABLE

**THANK YOU FOR YOUR SUPPORT!**

PLEASE VISIT OUR WEBSITE &  
USE PROMO CODE:

**OOPSIBROKEIT**  
to receive

**50% OFF**

your spare parts purchase!

**THANK YOU FOR YOUR SUPPORT!**

PLEASE VISIT OUR WEBSITE &  
USE PROMO CODE:

**OOPSIBROKEITAGAIN**  
to receive

**50% OFF**

your spare parts purchase!

## 16.0 WARRANTY TERMS & CONDITIONS

Our goods come with guarantees that cannot be excluded under the Australian Consumer Law. You are entitled to a replacement or refund for a major failure and for compensation for any other reasonably foreseeable loss or damage. You are also entitled to have the goods repaired or replaced if the goods fail to be of acceptable quality and the failure does not amount to a major failure.

This warranty is provided in addition to your rights under the Australian Consumer Law. Directed Electronics Australia Pty Ltd (Directed Electronics) warrants that this product is free from defects in material and workmanship for a period of 12 months from the date of purchase or for the period stated on the packaging. This warranty is only valid where you have used the product in accordance with any recommendations or instructions provided by Directed Electronics.

This warranty excludes defects resulting from alterations of the product, accident, misuse, abuse or neglect. In order to claim the warranty, you must return the product to the retailer from which it was purchased or if that retailer is part of a National network, a store within that chain, along with satisfactory proof of purchase. The retailer will then return the goods to Directed Electronics.

Directed Electronics will repair, replace or refurbish the product at its discretion. The retailer will contact you when the product is ready for collection. All costs involved in claiming this warranty, including the cost of the retailer sending the product to Directed Electronics, will be borne by you.

**Email:** [admin@zero-x.com.au](mailto:admin@zero-x.com.au)

### **INDEMNITY**

You agree to defend, indemnify and hold harmless Zero-X and its subsidiaries and affiliates from and against any and all claims, proceedings, injuries, liabilities, losses, costs and expenses (including reasonable legal fees), including but not limited to, claims alleging negligence, invasion of privacy, copyright infringement and/or trademark infringement against Zero-X and its subsidiaries and affiliates, relating to or arising out of your breach of any provision of these terms, your misuse of Zero-X products or its services, or your unauthorized modification or alteration of products or software.

### **WARRANTY AND WARRANTY DISCLAIMER**

Zero-X has a limited warranty, whereby Zero-X warrants to you and only to you that this Zero-X Action Camera will be free from defects in materials and workmanship for one (1) year from the date of your purchase (unless a longer warranty period is required by law). The specifics of this Zero-X limited warranty are covered in this manual.

To the extent possible under governing law, other than the above product warranty for the Zero-X Action Camera you understand and agree that the Zero-X services are provided on an "as is" and "as available" basis.

Zero-X makes no warranty that the Zero-X product and services will meet your requirements or that use of the Zero-X services will be uninterrupted, timely, secure or error-free. Nor does Zero-X make any warranty as to the accuracy or reliability of any information obtained through Zero-X (including third party content), that any defects in the Zero-X products or services be corrected or that the Zero-X products or Zero-X services will be compatible with any other specific hardware or service.

Further, Zero-X does not warrant that Zero-X products or services or Zero-X servers that provide you with data and content are free of viruses or other harmful components.

Zero-X also assumes no responsibility for and shall not be liable, for any damages caused by viruses that may infect your Zero-X. In the event of any loss, damage or injury, you will not look to Zero-X to compensate you or anyone else. You release and waive for yourself and your insurer all subrogation and other rights to recover against Zero-X arising as a result of the payment of any claim for loss, damage or injury.

Zero-X equipment and services do not cause and cannot eliminate occurrences of certain events, including, and Zero-X makes no guarantee or warranty, including any implied warranty of merchantability or fitness for a particular purpose, that the Zero-X equipment and services provided will detect or avert such incidents or their consequences.

Zero-X does not undertake any risk that you or property, or the person or property of others, may be subject to injury or loss if such an event occurs. The allocation of such risk remains with you, not Zero-X.

Other than the above product warranty for the Zero-X products, its suppliers disclaim all warranties of any kind, whether express, implied, or statutory, regarding the Zero-X services, including any implied warranty of title, merchantability, fitness for a particular purpose, or non-infringement of third party rights.

Because some jurisdictions do not permit the exclusion of implied warranties, the last sentence of this section may not apply to you.

Zero-X hereby further expressly disclaims all liability for any claims for service failures that are due to normal product wear, product misuse, abuse, product modification, improper product selection or your non-compliance with all applicable federal, state or local laws.

This warranty and warranty disclaimer give you specific legal rights, and you may have other rights that vary by state, province, or country. Other than as permitted by law, Zero-X does not exclude, limit or suspend other rights you have, including those that may arise from the nonconformity of a sales contract.

For a full understanding of your rights, you should consult the laws of your state, province, or country. For our Australian customers: Please note that this warranty is in addition to any statutory rights in Australia in relation to your goods which, pursuant to the Australian Consumer Law, cannot be excluded.

#### **LIMITATIONS OF ZERO-X LIABILITY**

Under no circumstances will Zero-X be liable in any way for any content, including, but not limited to, the loss of content, any errors or omissions in any content, or any loss or damage of any kind incurred in connection with use of or exposure to any content posted, emailed, accessed, transmitted, or otherwise made available via Zero-X.

Zero-X liability for damages, especially for breach of duty or obligation, delay in performance, non-performance, or malperformance shall be precluded, except when these are due to negligent breaches of any significant contractual duty or obligation on the part of Zero-X. Any liability for negligence is limited to direct losses usually and typically foreseeable in such case. Should the claim for damages be based on wilful or grossly negligent breach of contractual duty or obligation on the part of Zero-X, the preclusion and limitation of liability mentioned in the preceding sentences will not apply. The preceding preclusion and limitation of liability will also not apply to claims for damages arising out of loss of life, bodily injury or health impacts for which Zero-X may be liable, or for non-contractual liability.

Some states and countries do not allow the exclusion or limitation of incidental or consequential damages, so the above limitation or exclusion may not apply to you. Additionally, this provision is not intended to limit Zero-X's liability in the event of Zero-X's wilful or intentional misconduct.



Capture the skies.™

**ZERO-X**

ANOTHER  
DIRECTED  
BRAND

[www.zero-x.com.au](http://www.zero-x.com.au) | [www.zero-x.co.nz](http://www.zero-x.co.nz)



All Images, Information and Content are  
Copyright © 2022 Directed Electronics  
Australia Pty Ltd. All Rights Reserved.

[www.directed.com.au](http://www.directed.com.au) | [www.directed.co.nz](http://www.directed.co.nz)

© Zero-X v2.0 2022